



- ▶ **High quality micro switches for a wide range of applications**
- ▶ **Designed for footswitch, hand control, joystick etc**
- ▶ **Excellent performance, high reliability and long service life**
- ▶ **UL/cUL and ENEC certification**

Specifications	
Contact resistance (initial)	Max. 100 mΩ Measured by ohm meter - open voltage < 1VDC, driver current -100 mA
Insulation Resistance (at 500 VDC / minute)	Min. 100 MΩ
Dielectric Strength	Min. 500VAC (50-60HZ)/minute between Live parts. Min. 1500VAC (50-60HZ)/minute between Live parts and dead metal parts
Operating Temperature Range	-40°C to 125°C (with no icing)
Vibration	10~55Hz, displacement 0.75 mm (p-p)
Electrical Service Life	Min. 10,000 operations
Electrical Operating Frequency	10~30 operations per minute
Mechanical Service Life	Min. 1,000,000 operations
Mechanical Operating Frequency	120 operations per minute
Operating application of the switch	Set the switch pushing distance from 60% to 90% of the specified OT value



Model Name	UL - cUL	ENEC
VA2-P1	0.1RA 125/250VAC μ T125 1E4	0.1A 125/250VAC μ T125 1E4
VA2-O3	3RA 125/250VAC μ T125 1E4	3A 125/250VAC μ T125 1E4
VA2-O6	6RA 125/250VAC μ T125 1E4	6A 125/250VAC μ T125 1E4
VA2-10	10RA 125/250VAC μ T125 1E4	10(4)A 125/250VAC μ T125 1E4
VA2-16	16RA 16GPA 125/250VAC μ T125 1E4 1/2HP 125/250VAC μ T55 1E4	16(4)A125/250VAC μ T125 1E4
VA2-20	20RA 125/250VAC μ T125 1E4 1/2HP 125/250VAC μ T55 1E4	20A 125/250VAC μ T125 1E4
VA2-26	26RA 125/250VAC μ T55 1E4	26A 125/250VAC μ T55 1E4
VA2-A03	3GPA 125/250VAC μ T85 1E4	3A 125/250VAC μ T85 1E4
VA2-A06	6GPA 125/250VAC μ T85 1E4	6A 125/250VAC μ T85 1E4
VA2-T6	6RA 125/250VAC μ T200 1E4	6A 125/250VAC μ T200 1E4

MODEL	Rating	B	D	N	L	S	H	Q
VA2	0.1A	✓	✓	✓	✓	✓	✓	✓
	3A	✓	✓	✓	✓	✓	✓	✓
	6A		✓	✓	✓	✓	✓	✓
	10A 10(4)A				✓	✓	✓	✓
	16A 16(4)A				✓	✓	✓	✓
	20A					✓	✓	✓
	26A							✓
	6A T200						✓	✓

NOTE: The symbol " ✓ " represents the result is accepted

Dimensions

Unless otherwise specified, a tolerance of ± 0.4 mm applies to all dimensions.

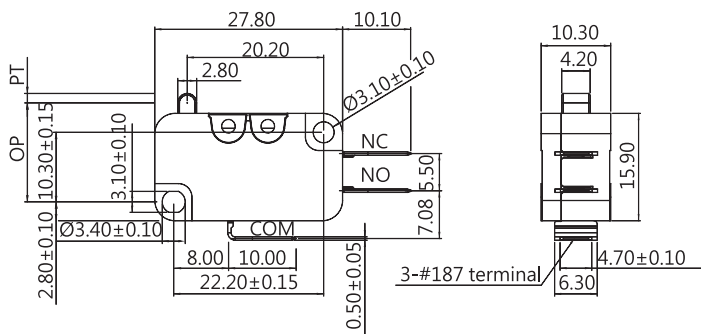

Contact configuration

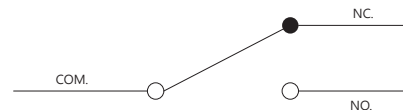

Mounting holes

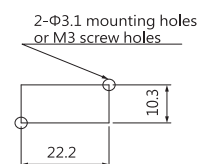



Terminal Types

A TYPE

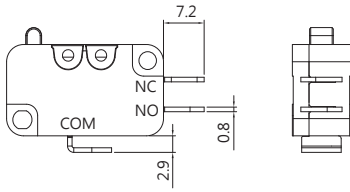

STANDARD

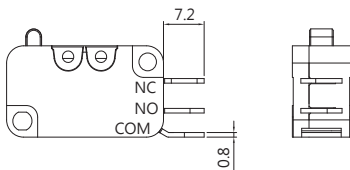

SIDE OUT

C TYPE
250 terminal
(6.3x0.8)

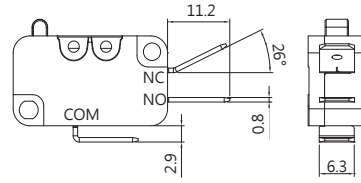

STANDARD

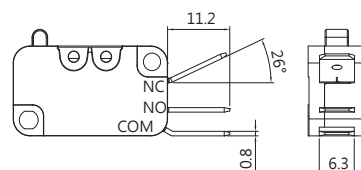

SIDE OUT

D TYPE
187 terminal
(4.7x0.5)

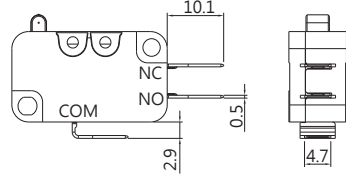

STANDARD

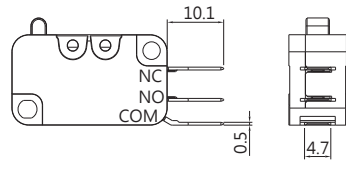

SIDE OUT

E TYPE
250 terminal
(6.3x0.8)

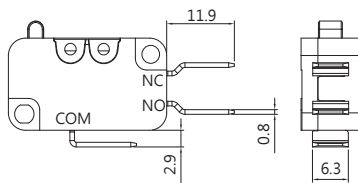

STANDARD

F TYPE
250 terminal
(6.3x0.8)

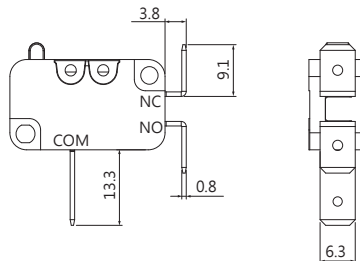

STANDARD

I TYPE
187 terminal
(4.7x0.8)

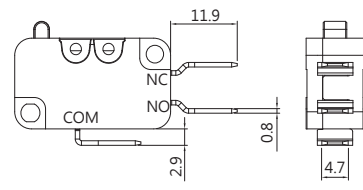

STANDARD

H TYPE
187 terminal
(4.7x0.8)

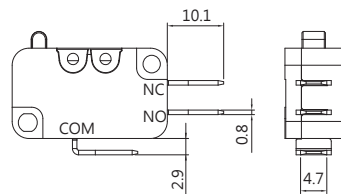

STANDARD

R TYPE
250 terminal
(6.3x0.8)

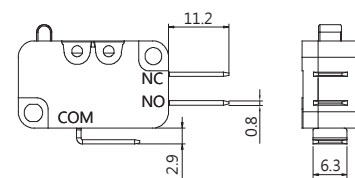

STANDARD

J TYPE
250 terminal
(6.0x0.8)

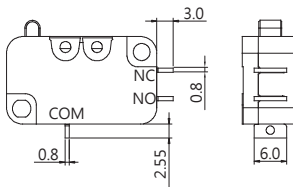

STANDARD

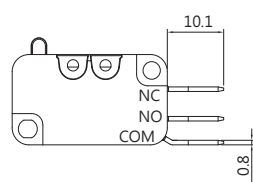

SIDE OUT

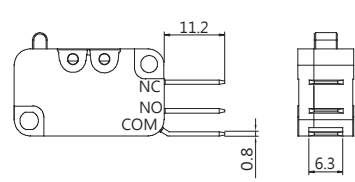

SIDE OUT

L TYPE
187 terminal
(4.7x0.5)

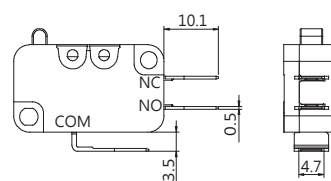

STANDARD



Ordering information

(Please use the characters in the chart below to create your product code)

Sample Code VA2 - 16 S 0 A - 00 D 0 - Z

Rating Current

P1	0.1A 125/250VAC T125
03	3A 125/250VAC T125
06	6A 125/250VAC T125
10	10A 10(4)A 125/250VAC T125
16	16A 16(4)A 125/250VAC T125
20	20A 125/250VAC T125
26	26A 125/250VAC T55
A03	3A 125/250VAC T85
A06	6A 125/250VAC T85
T6	6A 125/250VAC T200

Operating Force

Q	Heavier
H	Heavy
S	Standard
L	Light
N	Slight
D	Lightness
B	Extremely Lightness

Exterior Type

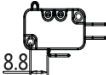
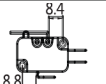
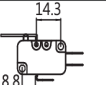
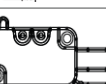
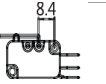
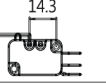
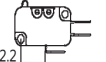
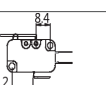
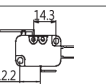
0	Standard Terminal No Actuator	
1	Standard Terminal Actuator Away Button	
2	Standard Terminal Actuator Near Button	
3	Side Out Terminal No Actuator	
4	Side Out Terminal Actuator Away Button	
5	Side Out Terminal Actuator Near Button	
6	Special Terminal No Actuator	
7	Special Terminal Actuator Away Button	
8	Special terminal Actuator Near Button	



Ordering information

(Please use the characters in the chart below to create your product code)

Sample Code VA2 - 16 S 0 A - 00 D 0 - Z

Mounting Holes Type

Mounting Holes 3.1



A Mounting Holes 2.9



Actuator Type

00 No Lever



Terminal Type

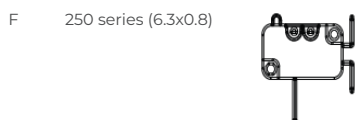
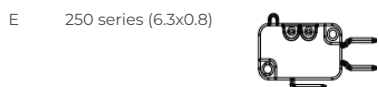
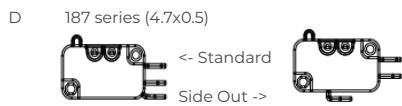
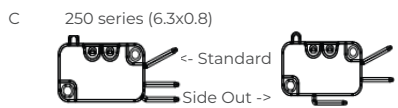
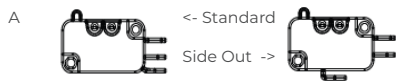



Ordering information

(Please use the characters in the chart below to create your product code)

Sample Code VA2 - 16 S 0 A - 00 D 0 - Z

Terminal Type

- H 187 series (4.7x0.8)

- I 187 series (4.7x0.8)

- J 250 series (6.0x0.8)

- L 187 series (4.7x0.5)

- R 250 series (6.3x0.8)

Circuit Arrangement

- 0 S.P.D.T.

- 1 S.P.S.T. NO

- 2 S.P.S.T. NC

Item	Rating Current	Operating Force
1	P1	ALL
2	03	ALL
3	06	D, N, L, S, H, Q
4	10	L, S, H, Q
5	16	L, S, H, Q
6	20	S, H, Q
7	26	Q
8	A03	ALL
9	A06	D, N, L, S, H, Q
10	T6	S, H, Q

If you require a customized solution for your program contact our sales team.



Operating characteristics

SWITCH TYPE	PART SUFFIX	OF Max. (gf)							OP (mm)	PT Max. (mm)	OT Min. (mm)	MD Max. (mm)
		B	D	N	L	S	H	Q				
VA2- □□□ 0-00D0-Z		18	45	75	110	170	230	330	14.7±0.5	1.72	0.8	0.4
VA2- □□□ 1-01D0-Z		18	45	75	110	170	230	330	15.3±0.5	2.8	0.6	0.5
VA2- □□□ 2-01D0-Z		8	27	43	50	85	120	175	15.3±1.1	5.2	1.55	0.9
VA2- □□□ 1-02D0-Z		8	22	37	50	86	125	180	15.3±1.5	5.9	1.6	1.0
VA2- □□□ 2-02D0-Z		5	16	25	30	51	65	90	15.3±2.3	9.7	3.1	2.2
VA2- □□□ 1-03D0-Z		6	13	25	30	49	70	120	15.3±2.5	9.3	-	2.1
VA2- □□□ 2-03D0-Z		4	8	15	20	30	35	50	15.3±4.3	16.2	-	3.5
VA2- □□□ 1-04D0-Z		10	28	43	65	110	140	205	18.7±1.5	5.5	1.4	1.1
VA2- □□□ 2-04D0-Z		7	16	24	35	56	70	100	18.7±2.1	8.7	3.2	1.7
VA2- □□□ 1-05D0-Z		20	55	80	110	170	230	330	20.7±0.8	2.7	0.6	0.45
VA2- □□□ 2-05D0-Z		8	35	55	70	100	120	175	20.7±1.1	4.65	1.4	0.8
VA2- □□□ 1-06D0-Z		8	30	45	65	100	125	180	20.7±1.5	4.2	1.6	1.25
VA2- □□□ 2-06D0-Z		7	20	30	40	51	65	90	20.7±2.2	9.3	2.8	1.8