

- ▶ **High quality micro switches for a wide range of applications**
- ▶ **Excellent performance, high reliability and long service life**
- ▶ **UL/cUL and ENEC certification**
- ▶ **Applications - Automotive (Seat Belt, Door Latch, Engine Hood, Door Trunk), Air Conditioner, Communication, Security System, Electric Tooth Brush, Toy**

Specifications	
Contact resistance (initial)	Max. 100mΩ Measured by ohm meter –Open Voltage<1VDC, Driver current -100mA
Insulation Resistance (at 500 VDC / minute)	Min. 100 MΩ
Dielectric Strength	Min. 150VAC (50-60HZ)/minute between live parts. Min. 500VAC (50-60HZ)/minute between live parts and dead metal parts
Operating Temperature Range	-40°C to +85°C (with no icing)
Vibration	10~55Hz, displacement 0.75 mm (p-p)
Electrical Service Life	10mA - Min. 500,000 operations 3A - Min. 6,000 operations
Electrical Operating Frequency	10~30 operations per minute
Mechanical Service Life	Min. 500,000 operations
Mechanical Operating Frequency	120 operations per minute
Operating application of the switch	Set the switch pushing distance from 60% to 90% of the specified OT value

Certification information

	UL - cUL	ENEC
DW-N2S	10 mA 12 VDC (Temp 65°C), Min. 10.000 Schaltzyklen	10 mA 12 VDC, μ T55 5E5
DW-N3S	3 A 12 VDC (Temp 65°C) Min. 10.000 Schaltzyklen 3 A 125 VAC (Temp 65°C) Min. 6,000 Min. 100.000 Schaltzyklen	3 A 12 VDC, μ T55 1E5

Dimensions

Es gilt eine Toleranz von +/- 0,4mm für alle Dimensionen, sofern nicht anders angegeben

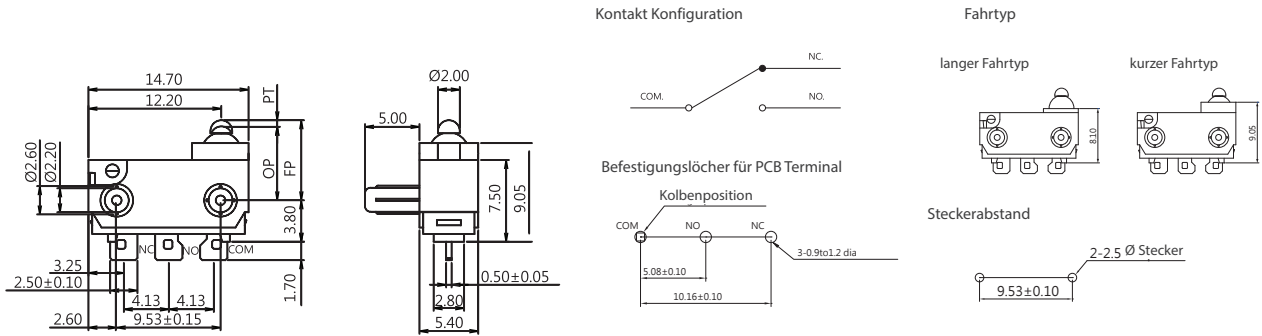

Terminal types

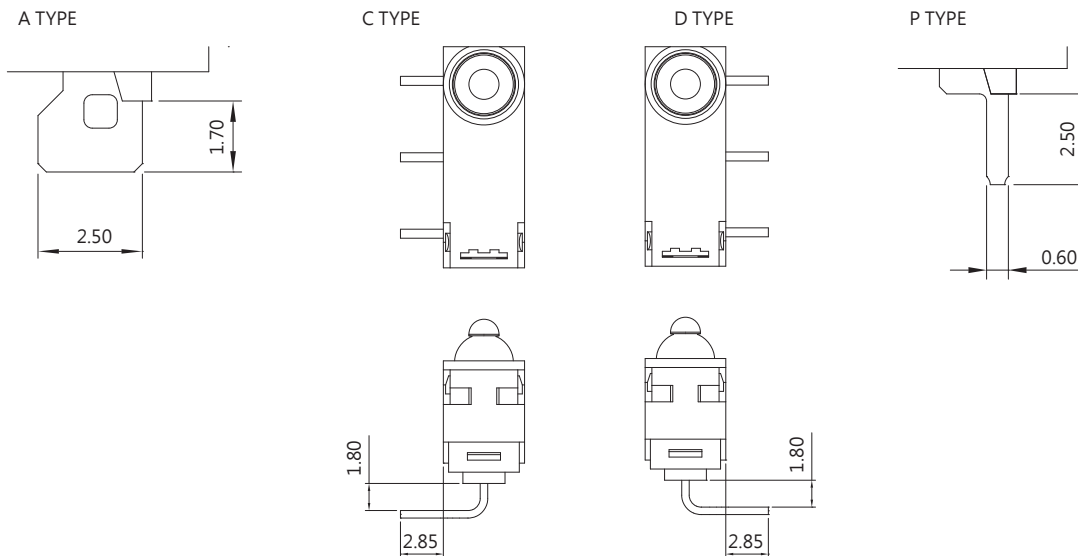



Cover Types (pillar and travel types)

SHORT TRAVEL

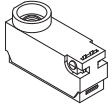

A TYPE

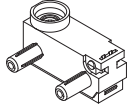

B TYPE

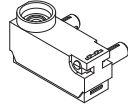

C TYPE

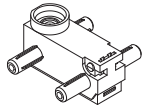

G TYPE

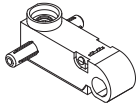

I TYPE

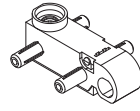

K TYPE

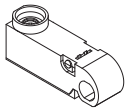

M TYPE

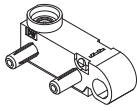

P TYPE

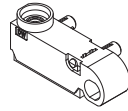

R TYPE

LONG TRAVEL

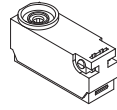

D TYPE

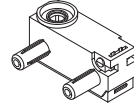

E TYPE

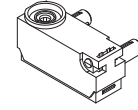

F TYPE

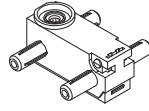

H TYPE

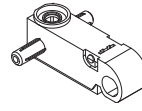

J TYPE

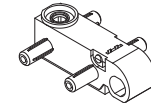

L TYPE

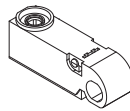

N TYPE

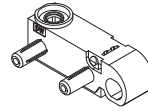

Q TYPE

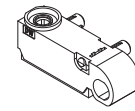

S TYPE

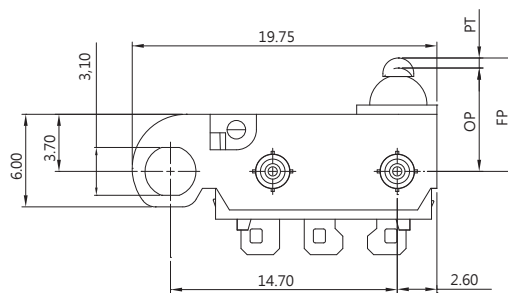
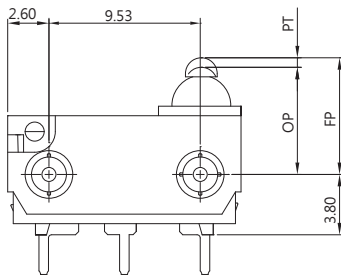



Ordering information

(Please use the characters in the chart below to create your product code)

Sample code DW - N2 S - 01 A 0 - A 0A - Z

Rating current

- N2 10mA 12VDC Contact Plated Gold and Terminal Plated Silver

- N3 3A 12 VDC

Actuator Type

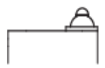
- 00 

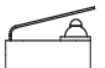
- 01 

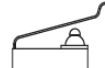
- 04 

terminal Type

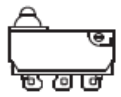
- A 

- C 

- D 

- P 

Circuit Arrangement

- 0 S.P.D.T.

- 1 S.P.S.T.NO

- 2 S.P.S.T.NC

If you require a customized solution for your program contact our sales team.



Ordering information

(Please use the characters in the chart below to create your product code)

Sample code DW - N2 S - O1 A 0 - A OA - Z

Pillar & Travel Type	
Short Travel	
A	
B	
C	
G	
I	
K	
M	
P	
R	

Pillar & Travel Type	
Long Travel	
D	
E	
F	
H	
J	
L	
N	
Q	
S	

Dimensions - Serial Code

See table below

If you require a customized solution for your program contact our sales team.

Dimensions

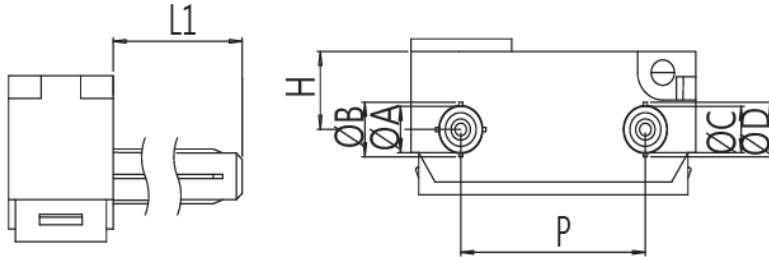

Code	L1	H	A	B	C	D	P
A	2.0	3.7	2.2	2.6	2.2	2.6	9.53
B	3.5	3.7	2.2	2.6	2.2	2.6	9.53
C	2.8	3.75	2.7	3.1 (three ribs)	2.2	2.6	9.53
D	4.0	3.7	2.2	2.6	2.2	2.6	9.53
E	0.9	3.7	2.2	N/A	2.2	N/A	9.53
F	1.8	3.7	2.5	N/A	2.5	N/A	9.53
G	5.0	3.7	2.4	2.8	2.4	2.8	8.0
I	2.8	3.75	2.2	2.6	2.2	2.6	9.53

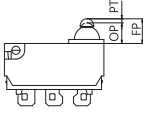
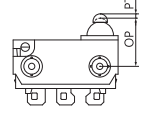
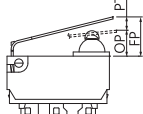
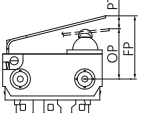
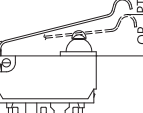
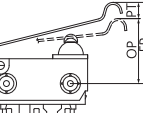

Operating characteristics

SWITCH TYPE	PART SUFFIX	OF Max (gf)		OP (mm)	PT Max (mm)	OT Min (mm)	MD Max (mm)	FP Max (mm)	RF Min (gf)
DW- □□ S-00 □□ -Z		S	130	3.05±0.2	0.8	0.8	0.3	3.65	35
				6.75±0.2				7.35	
DW- □□ S-01 □□ -Z		S	195	3.7±0.5	3.85	1.35	0.5	7.0	55
				7.4±0.5				10.7	
DW- □□ S-04 □□ -Z		S	160	6.2±0.8	4.8	1.65	0.7	10.1	45
				9.9±0.8				13.8	