

- ▶ **High quality micro switches for a wide range of applications**
- ▶ **Excellent performance, high reliability and long service life**
- ▶ **UL/cUL and ENEC certification**
- ▶ **Applications - Automotive (Seat Belt, Door Latch, Engine Hood, Door Trunk), Air Conditioner, Communication, Security System, Electric Tooth Brush, Toy**

Specifications	
Contact resistance (initial)	Max. 100mΩ Measured by ohm meter –Open Voltage<1VDC, Driver current -100mA
Insulation Resistance (at 500 VDC / minute)	Min. 100 MΩ
Dielectric Strength	Min. 500VAC (50-60HZ)/minute between live parts. Min. 1500VAC (50-60HZ)/minute between live parts and dead metal parts
Operating Temperature Range	-40°C to +85°C (with no icing)
Vibration	10~55Hz, displacement 0.75 mm (p-p)
Electrical Service Life	0.1A - Min. 100,000 operations 3A - Min. 10,000 operations
Electrical Operating Frequency	10~30 operations per minute
Mechanical Service Life	Min. 1,000,000 operations
Mechanical Operating Frequency	120 operations per minute
Operating application of the switch	Set the switch pushing distance from 60% to 90% of the specified OT value

Certification information

	UL - cUL	ENEC
DW2-03	0.1RA 3RA 12VDC μT55 1E5 3RA 24VDC μT55 5E4 0.1A 3RA 125/250VAC μT55 1E4	0.1A 3A 12VDC μT55 1E5 3A 24VDC μT55 5E4 0.1A 3A 125/250VAC μT55 1E4
DW2-G3	0.1RA 3RA 12VDC μT55 1E5 3RA 24VDC μT55 5E4 0.1RA 3RA 125/250VAC μT55 1E4	0.1A 3A 12VDC μT55 1E5 3A 24VDC μT55 5E4 0.1A 3A 125/250VAC μT55 1E4



Dimension

Unless otherwise specified, a tolerance of $\pm 0.4\text{mm}$ applies to all dimensions.

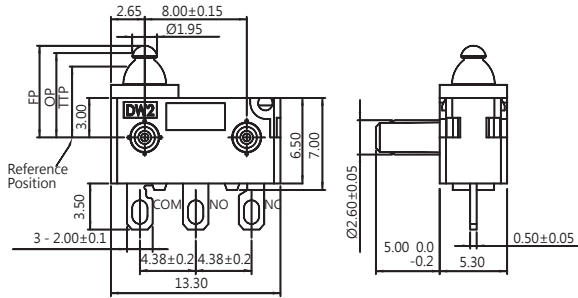

PILLAR PITCH

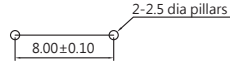

CONTACT CONFIGURATION



MOUNTING HOLES FOR PCB TERMINAL

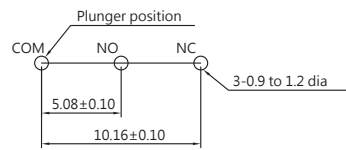

Cover types (Pillar and travel types)

A TYPE

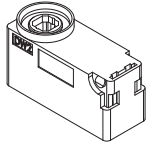

B TYPE

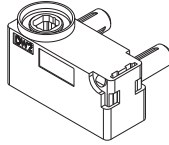

C TYPE

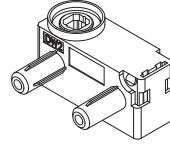

D TYPE

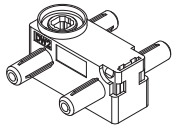

E TYPE

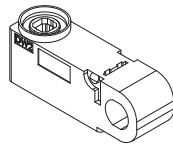

F TYPE

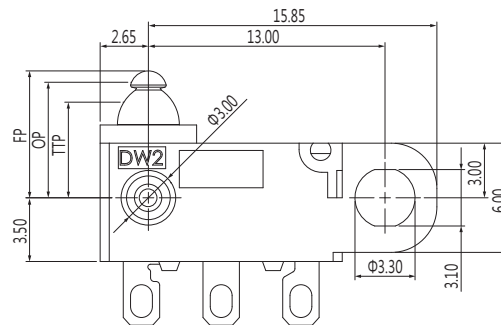
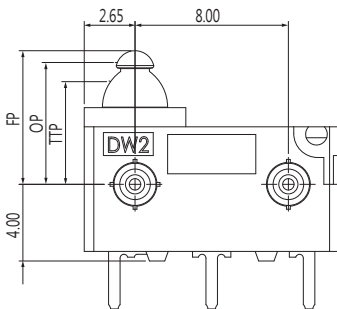
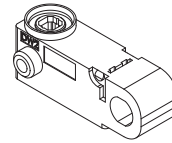



Dimensions

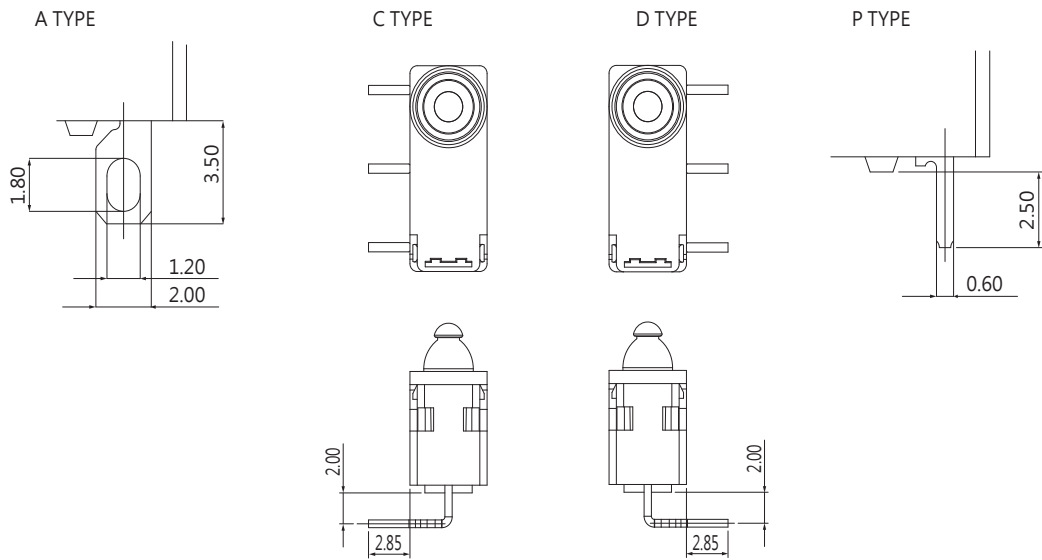



Ordering information

(Please use the characters in the chart below to create your product code)

Sample Code DW2 - 03 H - 01 A 0 A A - Z

Rating Current

G3 3mA 12VDC (Contact Plated Gold)

03 3A 125/250 VAC

Operating Force

S standard

H heavy

Actuator Type

00



01

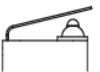

04

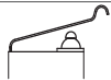

Terminal Type

A



C

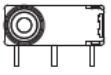

D

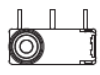

P

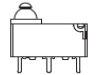

If you require a customized solution for your program contact our sales team.



Ordering information

(Please use the characters in the chart below to create your product code)

Sample Code DW2 - 03 H - 01 A 0 A A - Z

Circuit Arrangement

0	S.P.D.T.
1	S.P.S.T.NO
2	S.P.S.T.NC

Pillar Type

A	
B	
C	
D	
E	
F	

Pillar Type - Dimensions

See table below

If you require a customized solution for your program contact our sales team.



Pillar Type - Dimensions for B, C, D Type

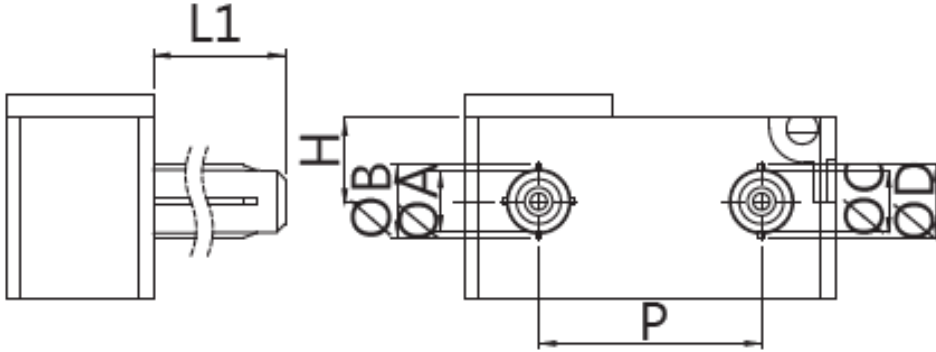

Code	L1	H	A	B	C	D	P
	5.0	3.0	2.2	2.6	2.2	2.6	8.0
A	2.0	3.0	2.2	2.6	2.2	2.6	8.0
B	4.0	3.0	2.2	2.6	2.2	2.6	8.0
C	0.7	3.0	2.5	N/A	2.5	N/A	8.0

Pillar Type - Dimensions for F Type

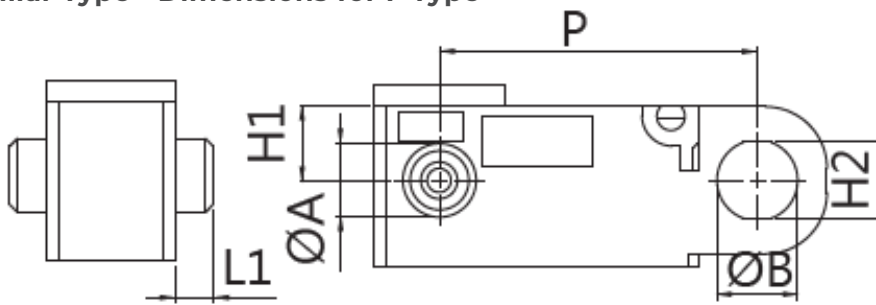

Code	L1	H1	H2	A	B	P
	1.5	3.0	3.1	3.0	3.3	13.00

If you require a customized solution for your program contact our sales team.

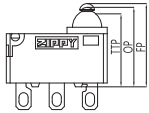
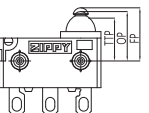
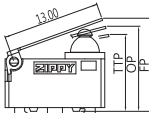
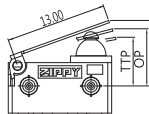
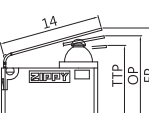
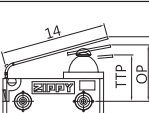

Operating characteristics

SWITCH TYPE	PART SUFFIX	OF		OP (mm)	TTP Max (mm)	OT Min (mm)	MD Max (mm)	FP Max (mm)	RF Min (gf)
		Max (gf)							
DW2- □□ S-00 □□ -Z		S	95	10.4±0.2	9.1	1.1	0.25	11.2	10
		H	150						20
		S	95	6.4±0.2	5.1			7.2	10
		H	150					20	
DW2- □□ S-01 □□ -Z		S	95	11.5±0.5	10	1.0	0.5	12.8	7
		H	150						13
		S	95	7.5±0.5	6			8.8	7
		H	150						13
DW2- □□ S-A01 □□ -Z		S	183	11.4±0.5	9.8	1.1	0.5	13.3	20
		H	220						38
		S	183	7.4±0.5	5.8			9.3	20
		H	220						38