



- ▶ **High quality micro switches for a wide range of applications**
- ▶ **Excellent performance, high reliability and long service life**
- ▶ **UL/cUL and ENEC certification**
- ▶ **Applications - mouse, joystick, small home appliance, central heating control**

Specifications	
Contact resistance (initial)	Max. 100mΩ Measured by ohm meter –Open Voltage<1VDC, Driver current -100mA
Insulation Resistance (at 500 VDC / minute)	Min. 100 MΩ
Dielectric Strength	Min. 500VAC (50-60HZ)/minute between live parts. Min. 1500VAC (50-60HZ)/minute between live parts and dead metal parts
Operating Temperature Range	-40°C to +85°C ( with no icing )
Vibration	10~55Hz, displacement 0.75 mm (p-p)
Electrical Service Life	0.1A - Min. 1,000,000 operations Other ratings - Min. 10,000 operations
Electrical Operating Frequency	10~30 operations per minute
Mechanical Service Life	Min. 1,000,000 operations
Mechanical Operating Frequency	120 operations per minute
Operating application of the switch	Set the switch pushing distance from 60% to 90% of the specified OT value



**Certification information**

	UL - cUL	ENEC
DF-01	1RA 125/250VAC μT55 1E4 1RA 24VDC μT55 1E4	1A 125/250VAC μT55 1E4 1A 24VDC μT55 1E4
DF-03	3A 125VAC (Temp:65°C ) Min. 6000 operations	3A 125VAC μ T55 1E4
DF-G3	3A 125VAC (Temp:65°C) Min. 6000 operations	None

**Selection of rating & force**

MODEL	Rating	L	S
DF	0.1A	★	★
	1A	★	★
	3A	★	★

NOTE: The symbol " ★ " represents the result is accepted

## Dimensions

Es gilt eine Toleranz von +/- 0,4mm für alle Dimensionen, sofern nicht anders angegeben

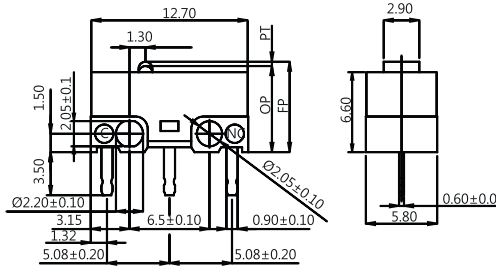

ideale Druckauslösung ist senkrecht mit +/- 4°

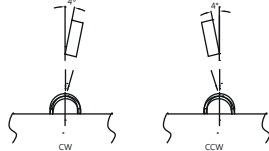

Verfügbar für PC Maus Variante mit Füßen, die mehr als 0,1mm hoch sind

Kontakt Konfiguration

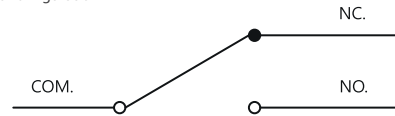

Befestigungslöcher

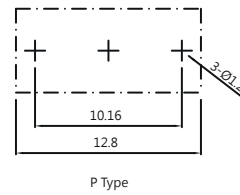

## Terminal types

A TYPE

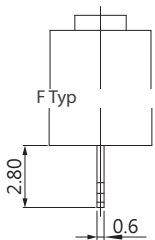

C TYPE

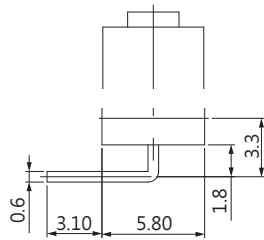

D TYPE

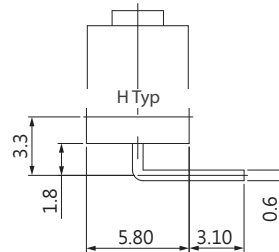

E TYPE

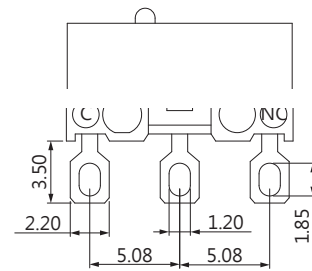

F TYPE

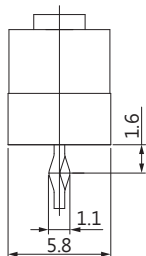

H TYPE

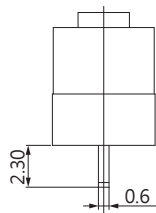

P TYPE

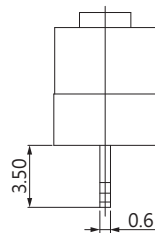



## Ordering information

(Please use the characters in the chart below to create your product code)

**Sample code**                      DF   -   P1        L        -        0                      P        -        M        -        Z

### Rating Current

P1	0.1A 125VAC
01	1A 125/250VAC
03	3A 125VAC
G1	0.1A 125VAC (Contact Plated Gold)
G3	3A 125VAC (Contact Plated Gold)
D3	3A 12VDC

### Operating Force

S	standard
L	light

### Actuator Type

0	
1	
2	
3	
4	
5	
6	
7	
8	
9	

If you require a customized solution for your program contact our sales team.



## Ordering information

(Please use the characters in the chart below to create your product code)

**Sample code**      DF   -   P1      L   -   Q      P   -   M   -   Z

Terminal Type	
A	
C	
D	
H	
F	
P	
E	

If you require a customized solution for your program contact our sales team.



Operating characteristics

SWITCH TYPE	PART SUFFIX	OF Max. (gf)	OP (mm)	PT Max. (mm)	OT Min. (mm)	MD Max. (mm)	FP Max. (mm)	RF Min. (gf)
DF- □□□ -0□ -M-Z		L 80	7.0±0.2	0.62	0.2	0.12	7.35	21
	S 150	35						
DF- □□□ -1□ -M-Z		L 30	8.4±0.8	3.0	0.6	0.8	10.6	5
	S 56	8						
DF- □□□ -2□ -M-Z		L 25	10.5±0.8	3.5	0.6	1.0	13.2	5
	S 43	7						
DF- □□□ -3□ -M-Z		L 35	7.9±0.8	2.9	0.3	0.6	10.0	5
	S 57	12						
DF- □□□ -4□ -M-Z		L 39	8.1±0.8	3.0	0.6	0.7	10.3	6
	S 69	10						
DF- □□□ -5□ -M-Z		L 50	9.1±0.8	2.0	0.4	0.3	11.0	5
	S 70	11						
DF- □□□ -6□ -M-Z		L 30	8.5±0.8	3.0	0.6	0.8	10.7	3
	S 50	8						
DF- □□□ -7□ -M-Z		L 27	11.3±1.0	3.5	0.3	0.8	13.85	3
	S 48	8						
DF- □□□ -8□ -M-Z		L 33	8.2±0.8	2.8	0.6	0.7	11.2	5
	S 54	9						
DF- □□□ -9□ -M-Z		L 13	10.4±2.2	7.7	1.0	1.0	15.65	2
	S 21	10.15±2.3	3					