

Non-Contact Magnetostrictive Position Sensor

- Measuring length 50 to 5000 mm
- 16 bit resolution
- 0 - 10V, 0 - 20 mA, 4 - 20 mA single output
- 24 VDC power supply



Technical Specifications	
Measurement stroke	50 - 5000 mm
Resolution	16 bit
Linearity	±0,05% full scale (min. 100 µm)
Repeatability	±0,01% (full scale)
Single output	0-10V, 10-0V, 0-20 mA, 20-0 mA, 4-20 mA, 20-4 mA
Power supply	24 VDC ±10%
Displacement speed	max. < 5 m/s
Update time	(0-600mm, 0,5ms), (600-1500mm, 1ms), (1500-3000mm, 2ms), (1501-5000mm, 3ms)
Load resistance	500 Ohm
Max. consumption	50 mA - 90 mA (depending on stroke length)
Max. output noise	< 5 mVpp
Reverse polarity protection	Up to -30 VDC
Overvoltage protection	Up to +30 VDC
Vibration	EN 60068-2-6 , 5-200 Hz 200 m/s ² [20g] , 2h 30 min each axis (x,y,z)
Shock	EN 60068-2-2:2007 500 m/s ² [50g] , 11ms. (x,y,z axis)
Case dimensions	33 mm x 33 mm
Case material	Anodized aluminium
Mechanical fixing	Variable brackets
Protection level	IP 67
Operating temperature	-10°C ... +70°C
Storage temperature	-30°C ... +90°C

Mechanical Specifications

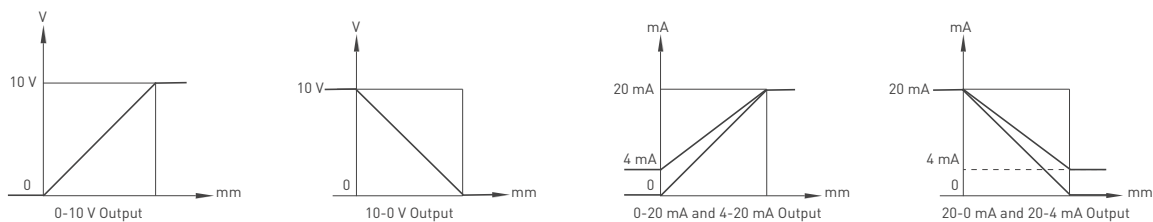
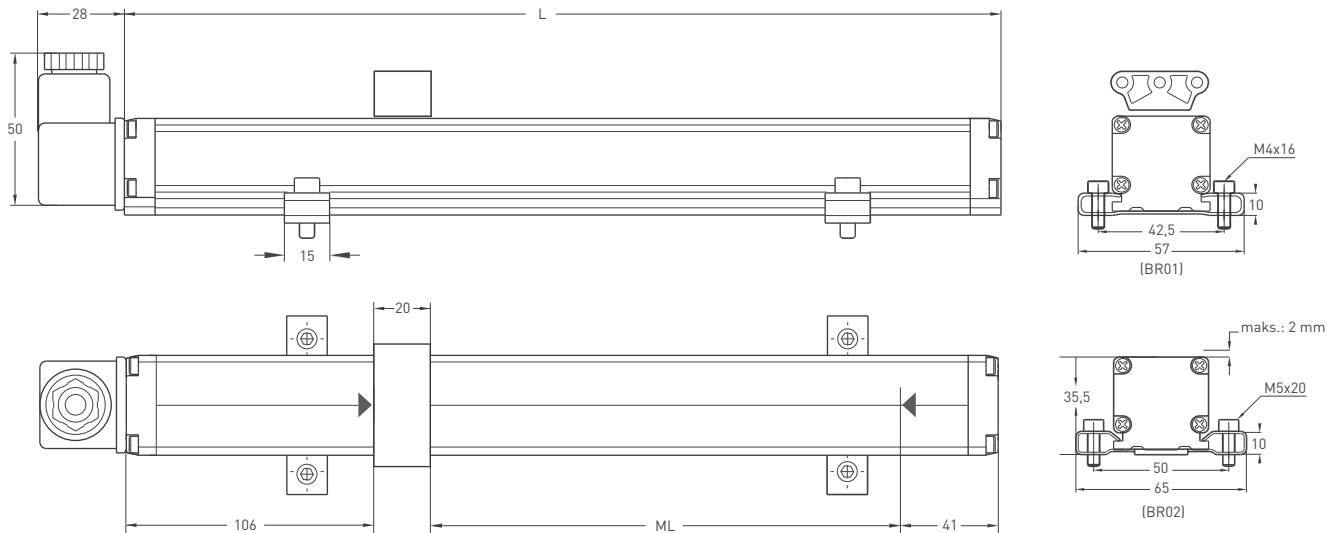

MSS (mm)	50	100	150	200	250	300	350	400	450	500	550	600	650	700	750	800	850	900	1000	1100	1200	1300	1400	1500	1750	2000	2250	2500	3000	4000	5000
ML (Measuring Length)	50	100	150	200	250	300	350	400	450	500	550	600	650	700	750	800	890	900	1000	1100	1200	1300	1400	1500	1750	2000	2250	2500	3000	4000	5000
L (Total Length)	217	267	317	367	417	467	517	567	617	667	717	767	817	867	917	967	1017	1067	1167	1267	1367	1467	1567	1667	1917	2241	2491	2741	3261	4281	5281
Dead Zone Calculation	106/41																														

Hydraulic Type Connector

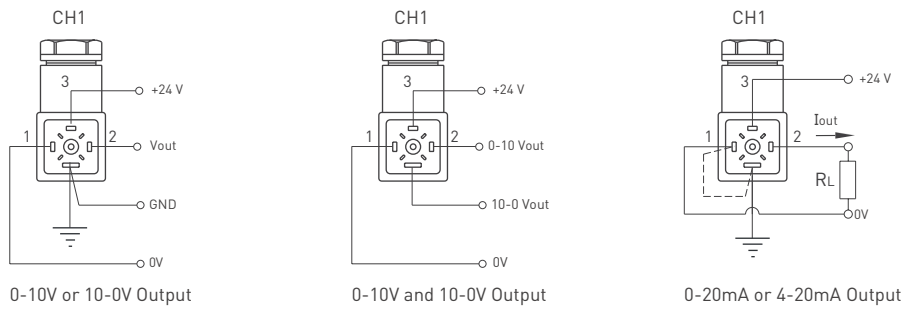

Cable

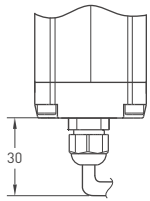

Voltage Output

+V : Brown
 0V : Blue
 0V Sense : Black
 Output 1 : White (0-10V)
 Output 2 : Orange (10-0V)
 Earth : Shield

Current Output

+V : Brown
 0V : Blue
 0V Sense : Black
 Output 1 : White (Iout1)
 Output 2 : Orange (Iout2)
 Earth : Shield

Cable Length

1M : 1 meter (standard)
 [Different cable length optional.]

Cursor

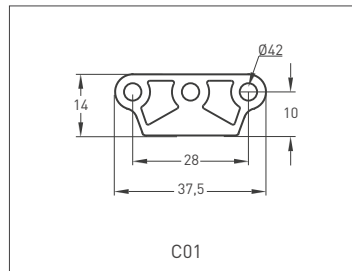

Ordering Procedure

Model	Measuring range	Resolution	Cursor	Single output	Cable	Bracket	Dead zone
MSSP	300	A	C01	V10	CH1	BR02	106/41
MSSP	50 - 5000 mm	A: 16 bit B: 15 bit C: 14 bit D: 13 bit E: 12 bit	1C01: 1 cursor 2C01: 2 cursors	V10 : 0-10V V01 : 10-0V I40 : 4-20mA I20 : 0-20mA I02 : 20-0mA	1M : 1 meter 2M5 : 2,5 meter	BR01 BR02	≤ 2000 mm : 106/41 > 2000-3000 mm : 215/41 > 3000-4000 mm : 235/41 > 4000-5000 mm : 255/41